

# COUNTERSINK WITH INTERCHANGEABLE INSERTS

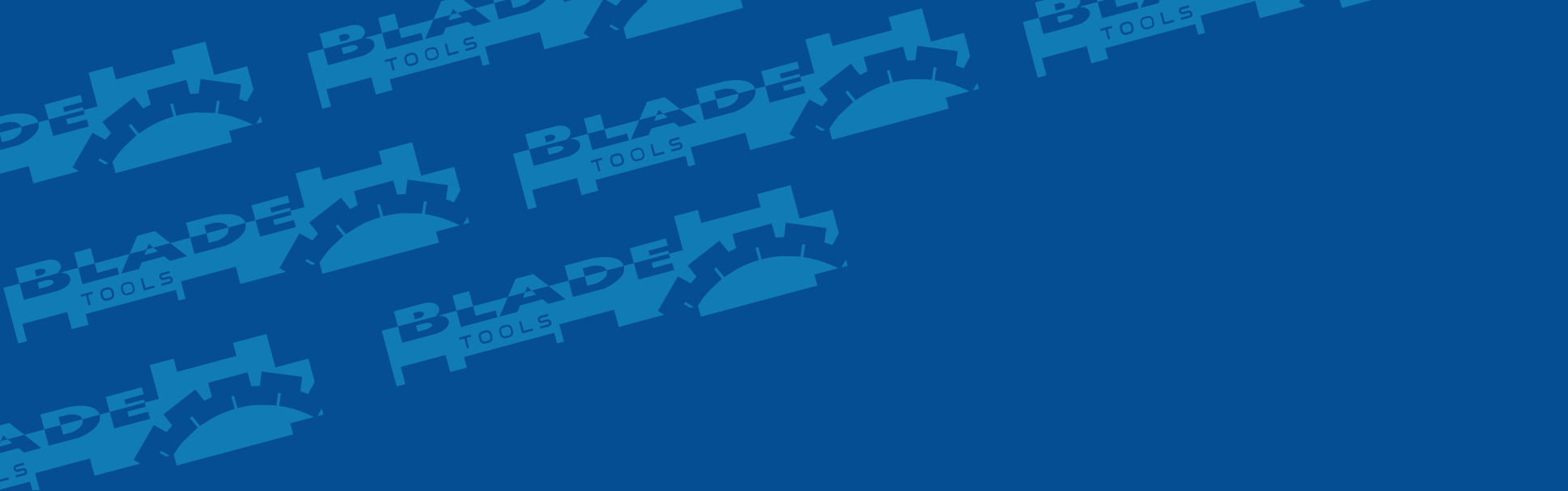

REV 2024.02



**Why choose us?**  
 We don't sell products,  
 we sell solutions.

## COUNTERSINK WITH INTERCHANGEABLE INSERTS

The countersink is one of the most commonly found tools in a metalworking factory.

From the countersinking of the tube sheet holes for heat exchangers, the idea of an **innovative tool** was born, inspired by the traditional HSS countersink but with an extra gear.

This article has been designed for use on **DRILL PRESS MACHINES**

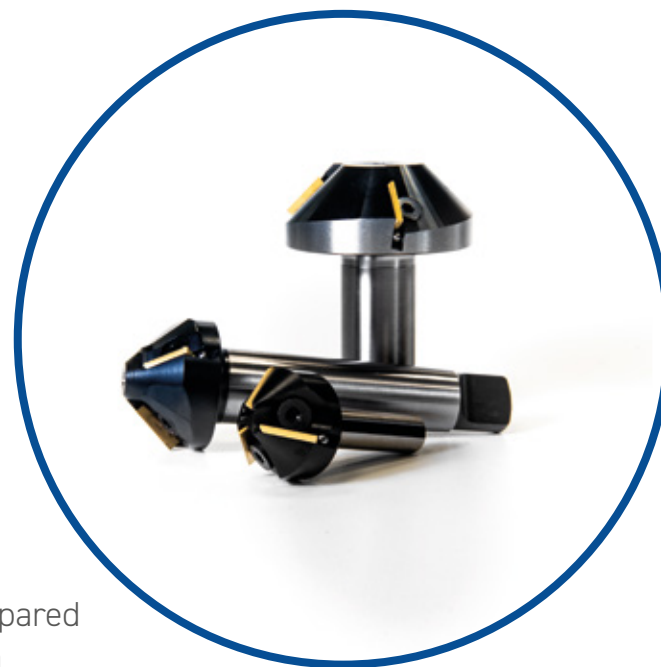

The need to ensure **repeatability over time**, **durability** and improved **performances** compared to a common countersink, led us to design a **countersink** with interchangeable inserts.

The three eccentric screws allow you to quickly change the inserts, obtaining in a few seconds a new countersink ready for use.

In this way it is possible **to reduce the number of countersinks needed in production**, avoiding the management of their resharpening.

## COUNTERSINK BODIES

There are available different countersinks that allow you to work from  $\varnothing 10$  up to  $\varnothing 63$ , with various possible connections. The countersink body is supplied complete with 3 eccentric screws, without mounted inserts (the inserts must be purchased separately).

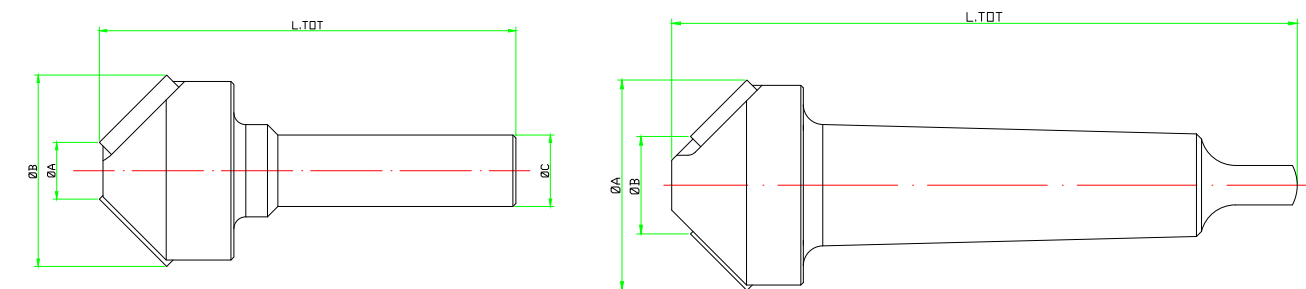

Body code	C mm	B mm	A mm	L.tot mm	Z	Compatible inserts	Screw code
00.32.00	* $\varnothing 12$	10	32	70	3	00.16.08 HM.16.08	00.05.01
00.42.00	* $\varnothing 12$	20	42	74	3		
00.42.01	$\varnothing 25$	20	42	86	3		
00.42.02	CM3	20	42	125	3		
00.63.00	* $\varnothing 12$	41	63	74	3		
00.63.01	$\varnothing 25$	41	63	86	3		
00.63.02	CM4	41	63	150	3		

\* Countersinks with cylindrical attachment  $\varnothing 12$  have 3 planes to ensure better attachment to the spindle.



**OUR BEST SELLER**

We thought of a **kit that contains 5 countersinks in 1, ready to use.**

Our KIT00.32.00 is composed of a countersink body  $\phi$ 32 (which covers the countersink from  $\phi$ 10 to  $\phi$ 32) with 3 inserts already mounted.

Inside the package there is a blister with **12 spare inserts**, which therefore allow **4 complete changes.** To complete the kit there is torx flag key for changing the inserts.

**KIT00.32.00**

**THE BLADE TOOLS INSERT**

The insert is made by **HSSCo9%**, it is ground and sharpened with **logarithmic geometry, TiN coated.**

For use on a drill press, where vibrations are higher, **we recommend using the insert 00.16.08** in HSSCo that best supports the stresses.

**HM.16.08 is made by hard metal and have a TiN coating.**

The inserts **are sold in blisters of 12 pieces each**, thus allowing 4 complete countersink changes.



**00.16.08**

Insert code	Insert quality	Cutting speed					
		P	M	K	N	S	H
00.16.08	HSSCo9% + TiN	•• 5-30	•• 5-15	•• 8-30	• 10-35	• 5-10	• 5-10
HM.16.08	HM + TiN	•• 30-90	• 25-55	•• 40-120	•• 40-150		

**NOTES**

.....

.....

.....

.....

.....

.....

.....

.....

.....

.....

.....

.....

.....

.....

.....

.....

.....

.....

.....

.....

.....

.....

